

3-pole

Technical data

Motor starter for direct on-line starting with thermal release 4 kW

Marking to 94/9/EC	Ⓔ II 2 G Ex de IIC / Ⓔ I M 2 Ex de I		
EC Type Examination Certificate	PTB 98 ATEX 1087 U		
IECEX Certificate of Conformity	IECEX BK1 07.0038 U		
Marking accd. to IECEX	Ex de IIC		
Application temperature ¹⁾	-20 °C to +40 °C		
Rated voltage	Main contact	max. 690 V/AC	
Rated switching capacity	12 V to 690 V		
Rated current	Main contact	max. 20 A	
	Auxiliary contact	max. 6 A	
Power dissipation per pole	2 W		
Rated switching capacity AC3		Main contact	Auxiliary contact
	230 V	2.2 kW	4 A (AC-15)
	400 V	4 kW	
	690 V	4 kW	
Back-up fuse	20 A gL		
Terminal cross-section	Main contact	2 x 10 mm ² fine wire with wire end sleeve/single wire	
	Auxiliary contact/		
	Coil connection	2 x 2.5 mm ² fine wire with wire end sleeve/single wire	
	Signal contact	2 x 2.5 mm ² fine wire with wire end sleeve/single wire	
Weight	1.72 kg size 3		
Enclosure material	Glass-fibre reinforced polyester		
Enclosure colour	black		
Options	Auxiliary contact		

¹⁾ Depend on installation

| Ex-Built-in components |

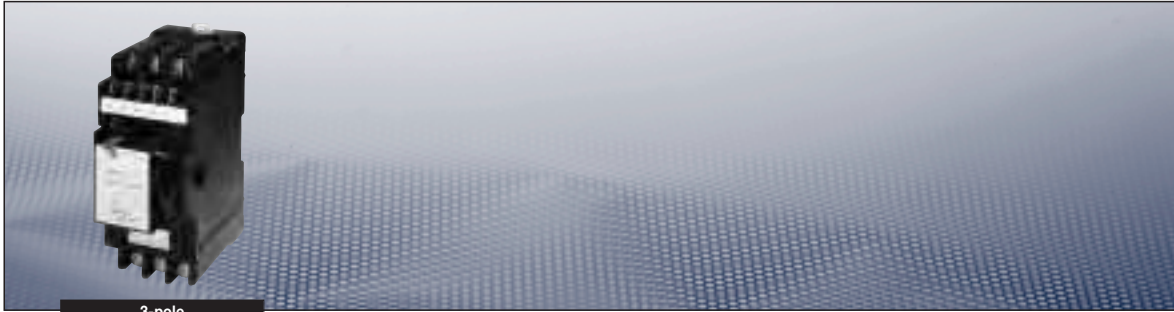

3-pole

Ex-Built-in components

Motor starter for direct on-line starting with thermal release 4 kW

GHG 618 3102 RXXYY

1. Rated current

2. Coil voltage

Ordering details Type: 3-pole

1. Rated current	XX	2. Coil voltage	YY
Module size 3 (70 mm)			
0.11 A - 0.16 A	01	110 V	04
0.16 A - 0.23 A	02	230 V	05
0.23 A - 0.36 A	03	240 V	06
0.36 A - 0.54 A	04	120 V	07
0.54 A - 0.80 A	05	400 V	08
0.80 A - 1.20 A	06	440 V	09
1.20 A - 1.8 A	07	380 / 400 V	10
1.8 A - 2.6 A	08	24 V DC	32
2.6 A - 3.7 A	09	48 V DC	34
3.7 A - 5.5 A	10	110 V DC	36
5.5 A - 8.0 A	11		
8.0 A - 11.5 A	12		

Example

GHG 618 31 02 R B C

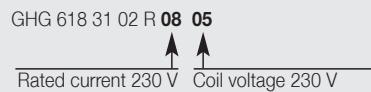

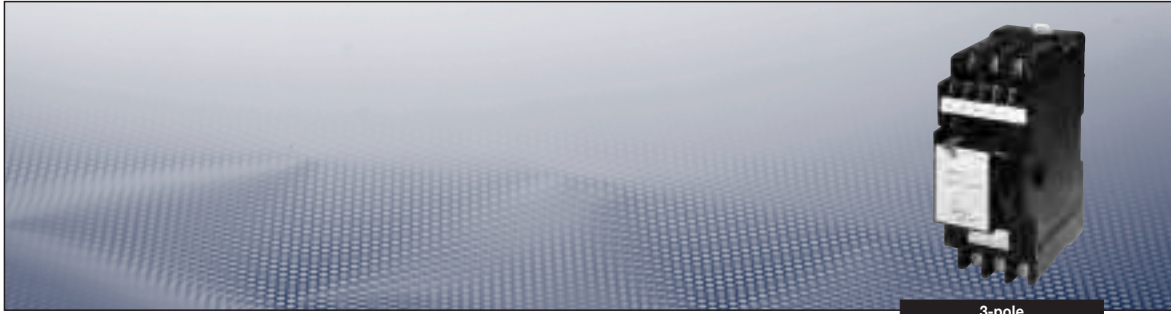

3-pole

Dimension drawing | Main contacts

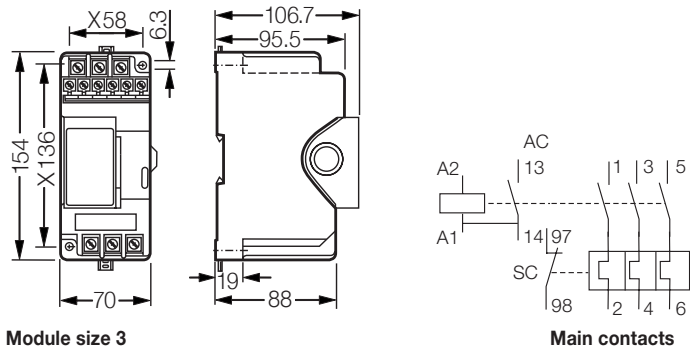

Module size 3

Main contacts

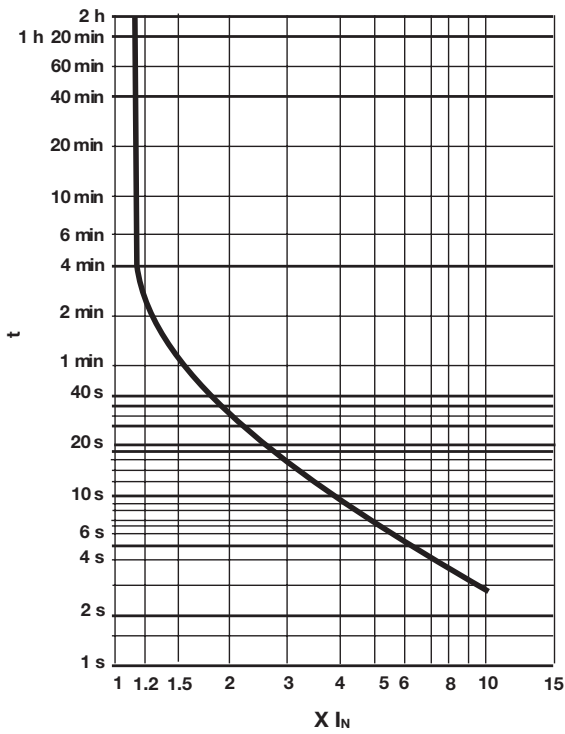

AC = Auxiliary contact
SC = Signal contact

Dimensions in mm