

FOC 25

**Technical data**

**Transport trolley with light source (Equipment 1)**

Marking to 94/9/EC	Ⓔ II 2 G EEx de IIC T4 <sup>1)</sup>
EC-Type Examination Certificate	PTB 02 ATEX 2179
Permissible ambient temperature	-20 °C to +40 °C
Rated voltage	220 V - 230 V AC
Rated current	1.8 A
Frequency	50 Hz
Ballast	EVG
Cable length	approx. 2.5 m with CEE-plug 16 A Zone 1
Insulation class	I
Lamp/illuminant	150 W Halogen metal vapour lamp
Degree of protection accd. EN 60529	IP66
Dimension (L x W x H)	1305 x 1000 x 600 mm
Type of mounting	mobile trolley
Enclosure material	Metal
Enclosure colour	yellow

**Fibre-optic base (Equipment 2)**

Marking to 94/9/EC	Ⓔ II 1 G Ex IIC T6
Degree of protection accd. EN 60529	IP67
Luminous flux	approx. 300 lm
Dimension (L x W x H)	25 m fibreoptic light guide cable
Total weight of the system	112 kg

<sup>1)</sup> Fulfils IEC 31WG8/TD3 protection against ignition by optic radiation

**Ordering details**

Type	Scope of delivery	Order No.
FOC 25	incl. 25 m light guide cable	1 3032 000 001

**Dimension drawing**

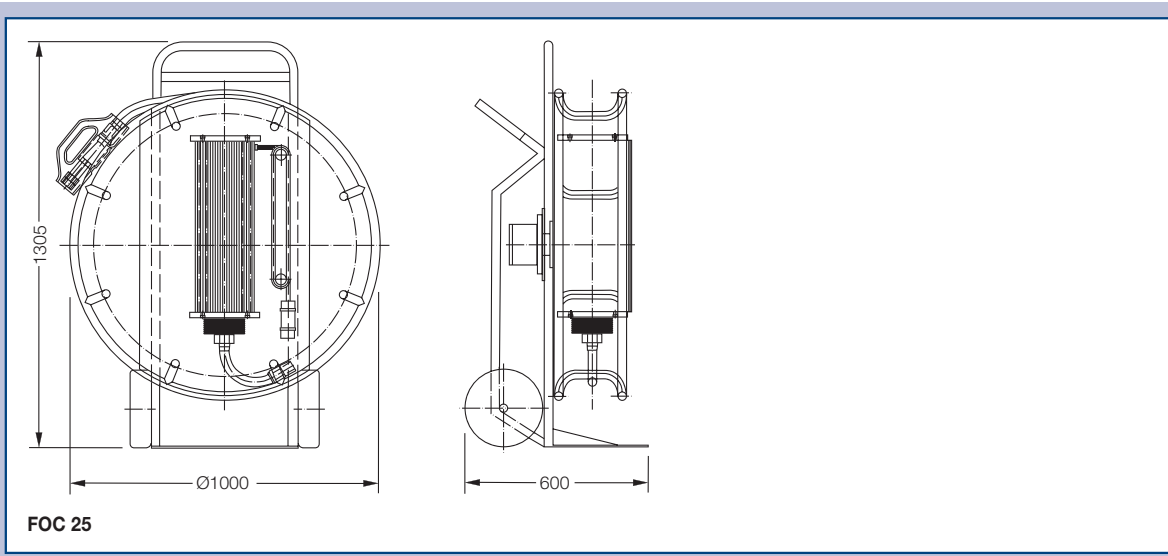

FOC 25

Dimensions in mm